

led profile by Luz Negra

A high quality silicone profile with front and side finishings in opal. It is suitable for perimetral decorative lighting, illuminating cavities, floor embedding etc.

It has two internal cavities which house an IP20 led strip, with a PCB of 10mm and a power not greater than 14W/m. We recommend combining this profile with ecoled Castellón.

Thanks to its IP67 waterproofing and its UV protection, this product is suitable for outdoor areas and damp zones (sealing the connector and the endcap with the recommended silicone is a must). We offer you this profile in 25m rolls or cut to size (minimum 1m MOQ).

We offer a 2 year guarantee.

NEON DOBLE

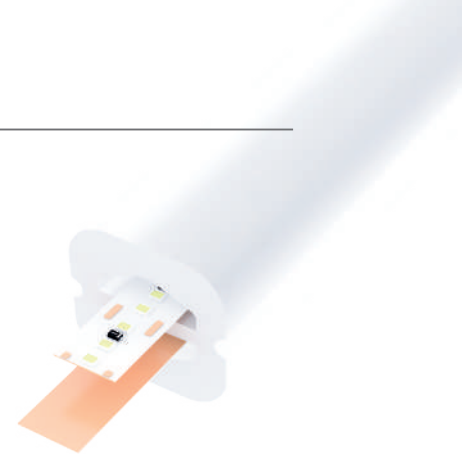

Scale 1:1

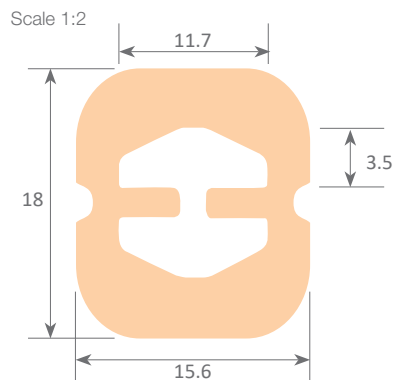
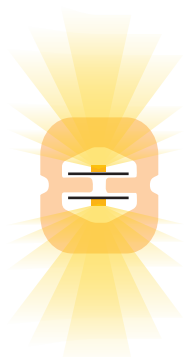

Neón Doble Led

10.008 Neón doble 1-25m
(PCB max. 10mm)



Silicone endcaps

19.179 without hole
19.180 with hole

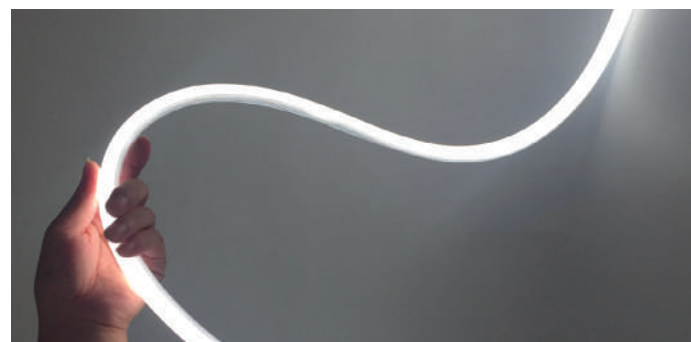

Clips

20.039 plastic
20.040 aluminium
20.065 plastic



Silicone for waterproofing

22.138 opal 45ml
22.140 transparente 45ml

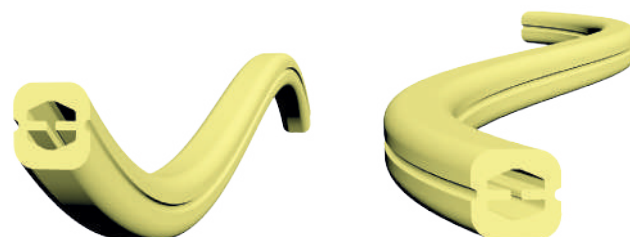

How to bend



CE

Variation in the tone of colour and luminous flow with neons

When we put a led strip inside a profile of silicone (like our neon profiles), the filtered light which coming out to the surface has a specific colour, where the tone depends on the profile of silicone

The following table of contents reflects the changes that have occurred on the strips with the most usual tones of colour (3000K – 4000K – 6000K).

Since the changes on the tone of colour depend also on other external factors like the IRC, the sealing systems, etc. This table serves for information purposes only and there is no commitment on the part of Luz Negra.

There is also a luminous flow reduction after the strip has been placed inside the profile of silicone (neon profile). This information is also reflected in the aforementioned table.

Name	3000K	4000K	6000K	Luminous flow reduction
Neon Micro	-400K	-900K	-1800K	-60%
Neon Mini	-300K	-800K	-1500K	-66%
Neon Cuadrado	-300K	-400K	-900K	-30%
Neon Redondo	-200K	-500K	-1000K	-24%
Neon XL	-400K	-700K	-1800K	-68%
Neon las Vegas	-400K	-700K	-1900K	-74%
Neon Doble	-100K	-200K	-700K	-25%
Neon Redondo XL	-300K	-600K	-1700K	-33%
Neon las Vegas XL	-300K	-500K	-1500K	-49%



Neon Micro



Neon Mini



Neon Cuadrado



Neon Redondo



Neon Redondo XL



Neon Doble



Neon XL



Neon las Vegas



Neon las Vegas XL