

## REMOTE CONTROL RGB/RGBW

## SEQUENCERS

Ref: 41.092

3V

- For RGB or RGBW led controller.
- Ultra sensitive colour adjustment touch wheel.
- Independent dimming function of each R, G, B, W channel to achieve millions of colours.
- Each remote can match one or more receivers.
- AAAx2 battery powered.
- Operates with led indicator light.
- Magnet on the back which can be fixed to back holder.

Compatible with receiver:

- 41.091



voltage



IP20

Voltage (V)	3V
Control	2.4GHz
Working current	< 5mA
Standby current	< 10µA
Distance control	30m
Measurements	122x53x17.5mm
Working temperature	-30°C / +55°C
Wall bracket	yes
Memory	yes
Control intensity	yes
Receiver included	no
Waterproofing	IP20
Packaging	1 unit
Guarantee	3 years

Approved by: 

### Measurements:

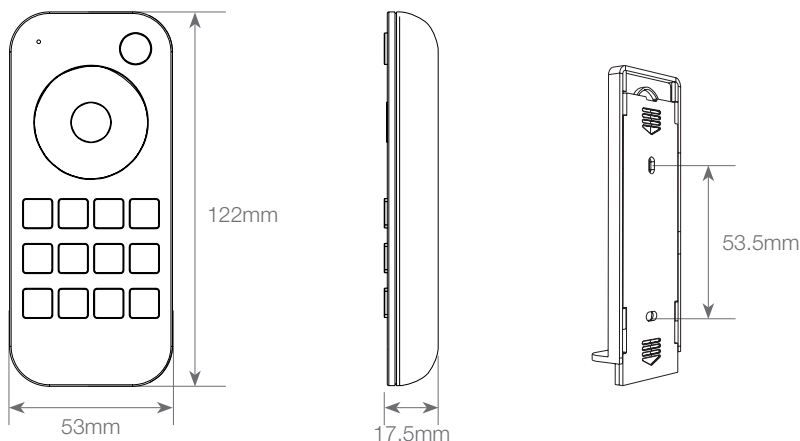

**BARCELONA**  
C/ Carles Buhigues, 13  
08420 Canovelles  
Info@luznegra.net  
Tel: +34 938 402 598

**MADRID**  
C/ Adaptación, 27  
28906 Getafe  
centro@luznegra.net  
Tel: +34 916 416 081

**PARIS**  
113 Avenue Joffre  
77450 Esbly  
france@luznegra.net  
Tel: +33 (0) 160 426 585

## REMOTE CONTROL RGB/RGBW

## SEQUENCERS

### Mechanical installation:

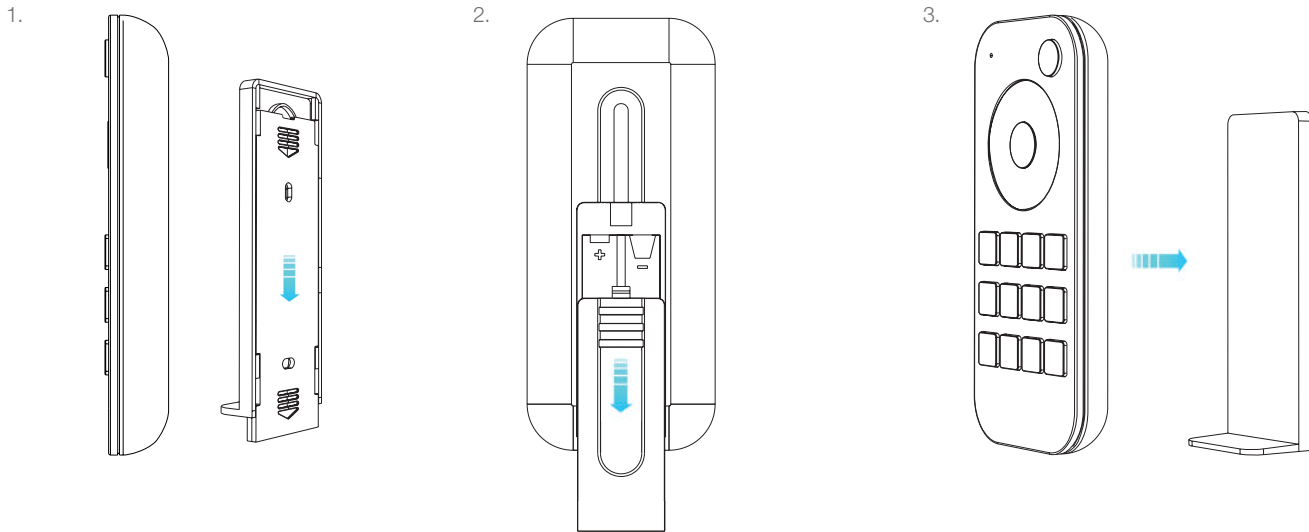

To fix the remote, three options are offered:

1. Fix the remote directly on to any metal surfaces.
2. Fix the remote back holder on the wall with 2 screws.
3. Adhere the remote back holder to the wall with paster.

### Operation

- When the light is on, the indicator displays blue, when the light is off, the indicator displays red.
- When you touch the colour wheel, the indicator will display the same colour.
- When you press or touch operation it's invalid (if the light is off), the indicator displays red.
- To extend battery life, no touch or press key operation after a few seconds, the touch wheel will enter sleep mode, you need to press any key to make touch wheel come out if sleep mode.

### Match remote control (two way match)

End user can choose the suitable match/delete ways. Two options are offered for selection:

- Use the controller's match key  
 Match: Short press match key, immediately press on/off key (single zone remote) or zone key (multiple zone remote) of the remote. The led indicator fast flashes a few times meaning match is successful.  
 Delete: Press and hold match key for 5 seconds to delete all match, the led indicator fast flash a few times means all matched remotes were deleted.
- Use Power Restart  
 Match: Switch off the power, then switch on power, repeat again. Immediately short press on/off key (single zone remote) or zone key (multiple zone remote) 3 times on the remote. The light blinks 3 times meaning match is successful.  
 Delete: Switch off the power, then switch on power, repeat again. Immediately short press on/off key (single zone remote) or zone key (multiple zone remote) 5 times on the remote. The light blinks 5 times meaning all matched remotes were deleted.

## REMOTE CONTROL RGB/RGBW

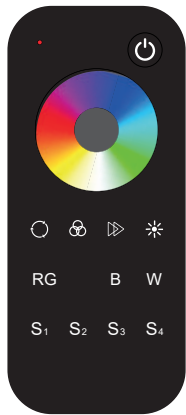

## SEQUENCERS

### Diagram:

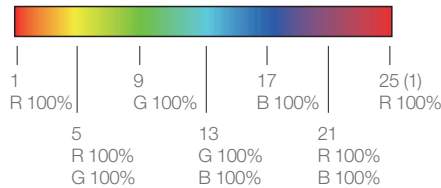

-  Light on/off.
-  Touch to change static RGB colour.
-  Short press gives 24 types of static RGB colour.  
Long press for continuous static colour adjustment.



-  Short press run next dynamic mode, long press 2 seconds run mode-cycle.  
For dynamic RGB mode, adjust speed, short press 10 levels, long press 2 seconds get the default speed.
-  For static RGB colour, adjust saturation, change current static RGB colour to mixed white slowly, short press 11 levels, long press 1-6 seconds for continuous 256 levels adjustment.
-  Adjust brightness, short press 10 levels, long press 1-6 seconds for continuous 256 levels adjustment.

-    Short press get red, green or blue colour directly.  
Long press 1-6 seconds to adjust R/G/B brightness continuously to achieve millions of colours.

-  For RGB light, short press turn on/off white(RGB mix), long press 1-6 seconds to adjust saturation continuously, change current static colour to mixed white slowly.  
For RGBW light, short press turn on/off W channel, long press 1-6 seconds to adjust W brightness continuously, change saturation by add white colour slowly.

-     Short press recall the scene, long press 2 seconds save current colour into S1/2/3/4.  
The led indicator displays green when save OK.

### Safety information

1. Read all instructions carefully before you begin this installation.
2. When installing battery, pay attention to the battery positive and negative polarities.  
If the remote is not to be used for a long time. Remove the battery.  
When remote distance becomes smaller and insensitive, replace the battery.
3. If no response from the receiver, please re-match the remote.
4. Handle the remote carefully.
5. Only for indoor use and dry locations.