

# RGBW control panel for embedding

Ref: 41.031

## Features:

- It is capable of controlling 4 different zones.
- 2.4GHz high RF wireless control with long distance controlling.
- It supports ON/OFF, colour, colour temperature, saturation and brightness control.
- Touch control, touch sensitive.
- Compatible with receivers: 41.026 / 41.071

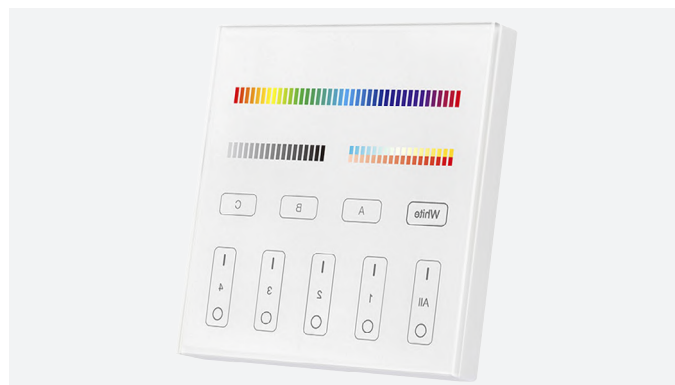

## Technical characteristics

### Technical data

Voltage	220V
Transmission Frequency	2.4GHz
Transmitting power	6dBm
Standby power	0.15W
Degree of protection	IP20
Zones	4
Speed mode +/-	Yes
Control type	Radiofrequency
"On"	Yes
"Off"	Yes
Memory	Yes

### Services

Regulation	Monocolour - CCT - RGB - RGBW - RGBW+CCT
Power supply	100 - 220AC
Apt for	Indoor
Fixing	Recessed
Maximum distance of signal reception	30m (without obstacles)
Connection type	Common anode
Front panel	Tempered glass

### Temperatures and operating conditions

Working temperature	-10°C / 40°C
---------------------	--------------



## Attention

1. The product should be installed by professionals.
2. Before switching on the power, please ensure that all wiring is correct, so as not to cause damage to the devices.
3. In the case of failure, please do not attempt to manipulate without the help of a specialised technician.



# RGBW control panel for embedding

## Link / unlink

### 1. Linking instructions:

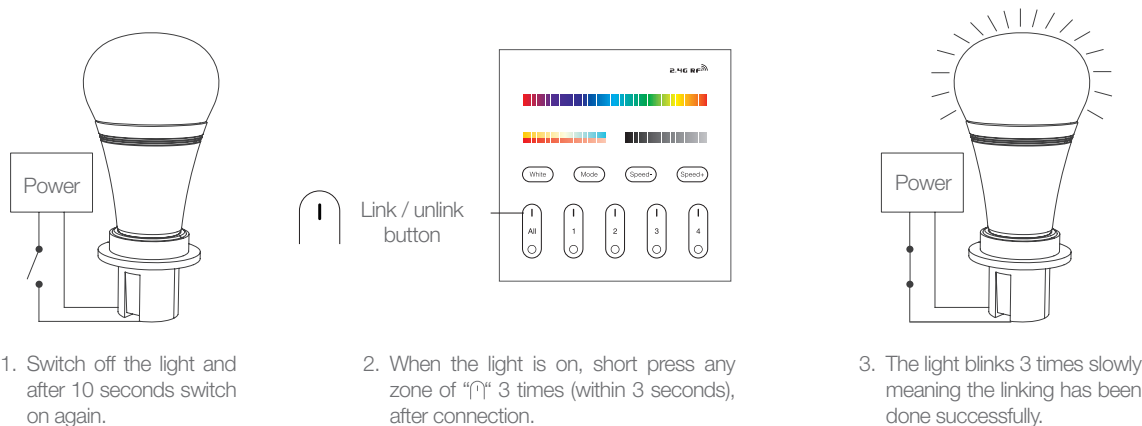

**!** If the light does not blink slowly, the linking has failed. Please switch off the light again and follow the above steps once more

### 2. Unlink instructions:

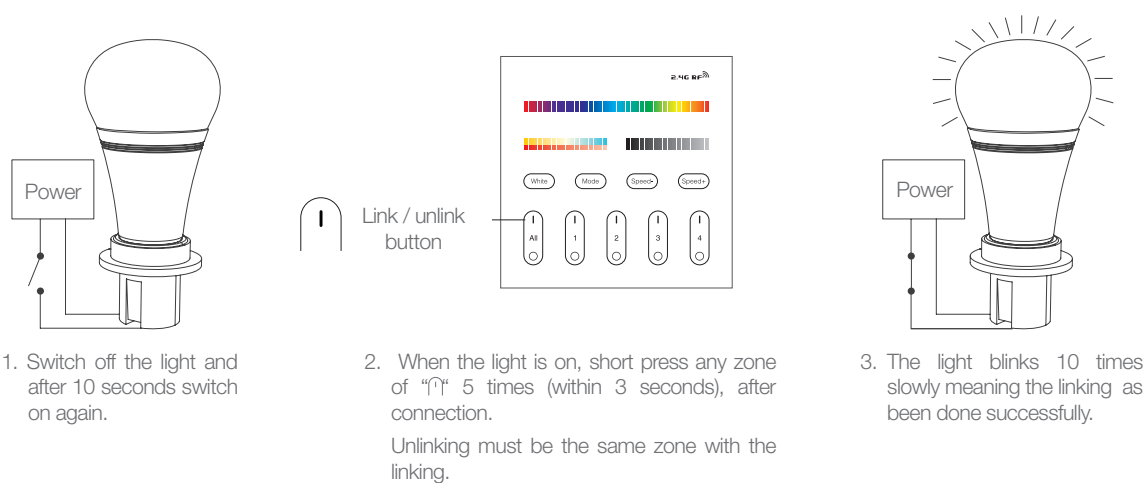

**!** If the light does not blink slowly, the linking has failed. Please switch off the light again and follow the above steps once more

# RGBW control panel for embedding

## 4-Zone Panel Remote

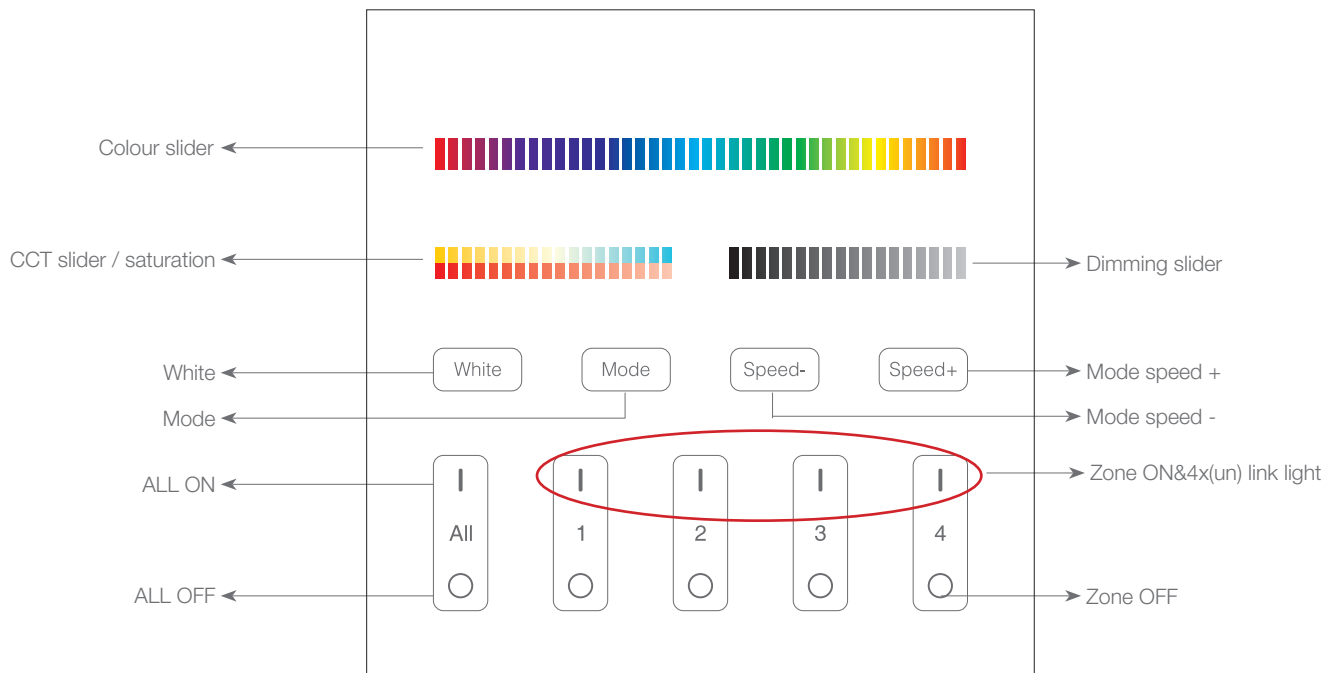

## Button function instruction



Touch colour slider, choose the color you want.



Under white light mode, adjust colour temperature.  
Under colour light mode, change colour saturation.



Touch dimming slider to change the brightness from 1~100%.



Touch white button to white light mode.



Switching modes.



Slow the speed on present dynamic mode.



Accelerate the speed on present dynamic mode.



- ALL ON: touch to turn on all linked lights. Long press 5 seconds to turn ON the indicating sound.
- ZONE 1-4 ON: touch zone ON, turn on zone-linked lights.



- ALL OFF: touch to turn off all linked lights. Long press 5 seconds to turn OFF the indicating sound.
- ZONE 1-4 OFF: touch zone OFF, turn off zone-linked lights.

# RGBW control panel for embedding

## Mounting / unmounting

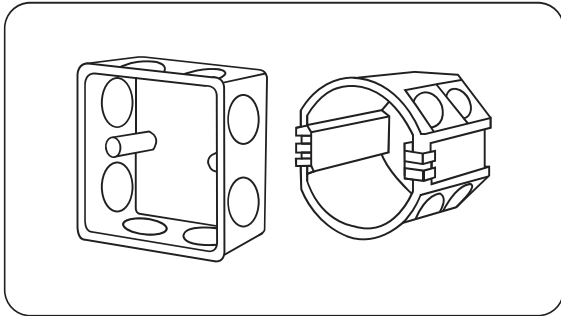

1. Install the box to the wall. Above are the standard boxes.

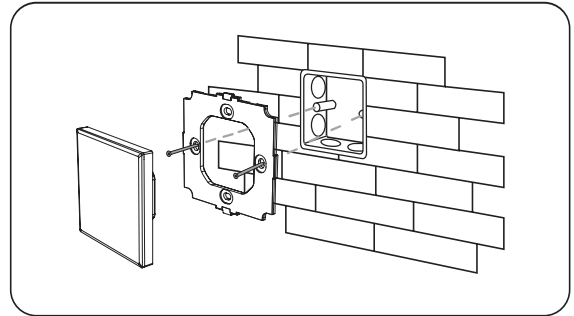

2. Fix the base on to the box on the wall.

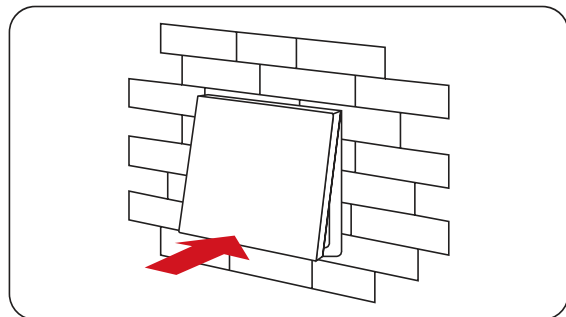

3. Fix the glass panel to the base.

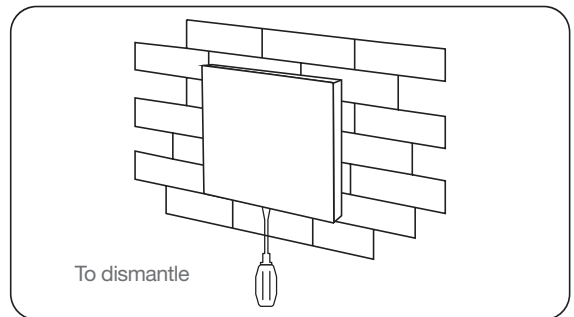

4. Insert the screwdriver carefully under the glass panel and gently push outwards.